

PIRAEUS RESIDENCES PROJECT 65



PIRAEUS



Located just southwest of Athens, Piraeus is a prominent coastal city that hosts Greece's largest port. Situated only 9 kilometers from the city center, Piraeus has played a strategic role in trade, maritime transport, and commerce since ancient times. With a modern transportation network including metro, tram, and bus lines, it offers easy access to central Athens. The city serves as a gateway to the Aegean Islands thanks to its bustling ferry and cruise traffic.

Piraeus also stands out for its vibrant social life, featuring a scenic coastline lined with restaurants, cafés, and traditional fish taverns. Neighborhoods like Mikrolimano and Kastella are popular for their sea views and historical charm. With its cultural institutions, museums, and theaters, Piraeus appeals to art lovers as well, making it an essential part of the Athens metropolitan area, offering both high quality of life and strong economic vitality.



Project

The project is located in Piraeus, right next to the port.

It offers a unique living experience in the heart of Piraeus, where modern elegance meets captivating sea views.

This modern 5-story residential building, situated adjacent to the port, combines contemporary design with functional living spaces. Comprising a total of 12 apartments, each unit has been thoughtfully designed to maximize comfort and natural light. The building is equipped with features that enhance residents' comfort.

The ground floor offers 4 duplex apartments with spacious layouts and premium interior finishes. The first, second, and third floors each have 2 apartments, while the top floor features an impressive penthouse. All units enjoy breathtaking sea views.

You can enjoy a peaceful lifestyle in a setting designed for relaxation and social gatherings in the city.



Project Details

Energy Certificate
A+

Heating
Yes, Available

Cooling
Split Air Conditioner (Split A/C)

Elevator
Yes, Available

View
Sea & City View

Delivery
2025

Property Management
Yes

Contract Compliance
Yes

Rental Eligibility
Yes

Golden Visa Eligibility
Yes



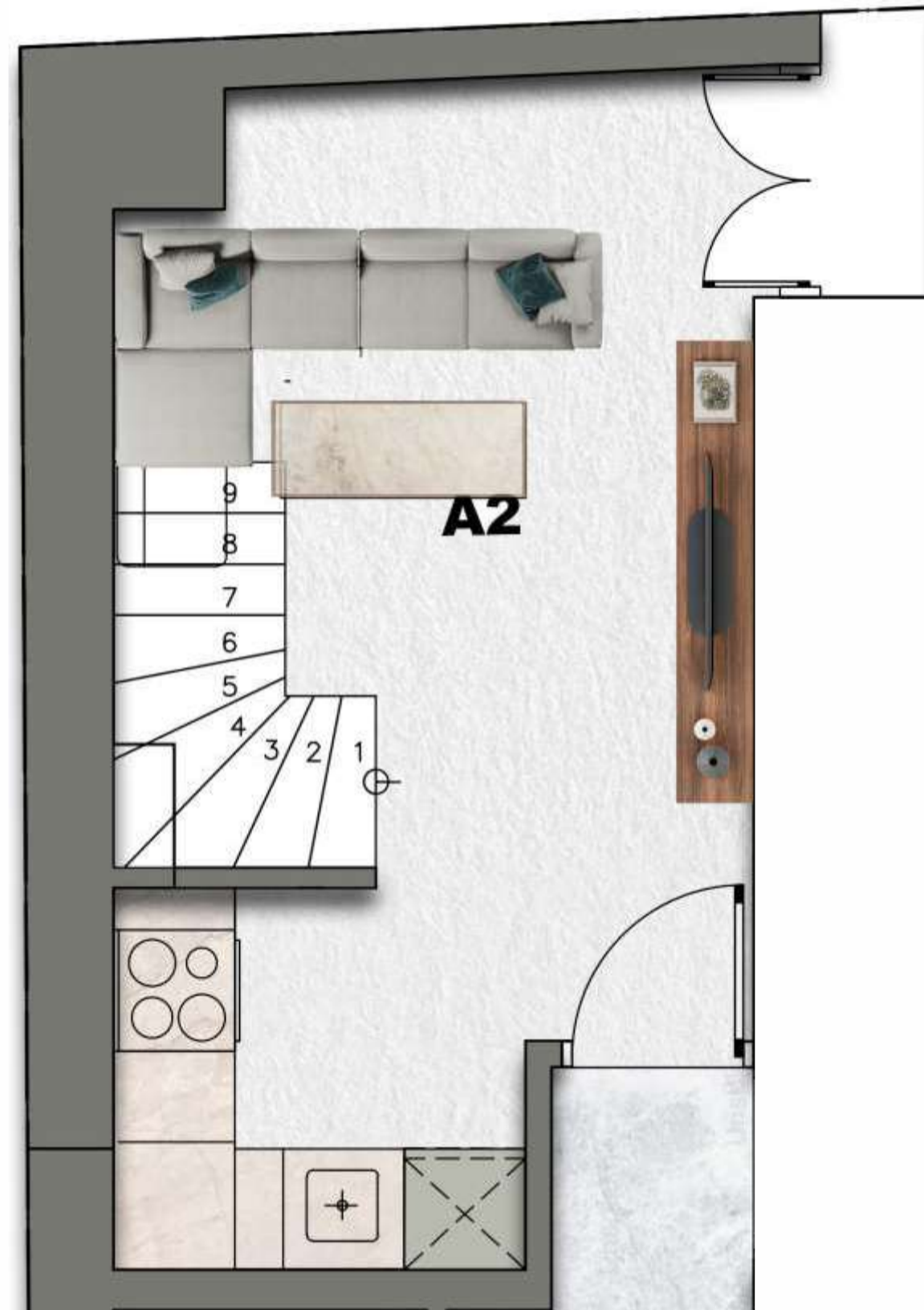

Lower Floor



Upper Floor

A2 - GROUND FLOOR

**1 Bedroom – 1 Living Room – 1 Bathroom – Duplex
50 m² + Veranda (3,5 m²) → Total Area : 53,5 m²
Starting From €210.000**

Property Details



B2 - 1st FLOOR

1 Bedroom – 1 Living Room – 1 Bathroom
51 m² + Veranda (3,5 m²) → Total Area : 54,5 m²
Starting From €220.000

Property Details



D2 - 3rd FLOOR

1 Bedroom – 1 Living Room – 1 Bathroom
50 m² + Veranda (3,5 m²) → Total Area : 53,5 m²
Starting From €240.000

Property Details



P1 - 4th FLOOR (PENTHOUSE)

Open-plan 1 Bedroom – 1 Living Room – 1 Bathroom – Terrace with Jacuzzi and Barbecue Area
36 m² Indoor Area + 16 m² Terrace → Total Area : 52 m²
Starting From €310.000





DISTANCES

The project is in an ideal location due to its proximity to the sea, transportation networks, and cultural centers;

Metro | 1 Minute Walking Distance

Airport | 1 Hour By Metro

Piraeus Port | 1 Minute Walking Distance

Piraeus Port (commercial Terminal) | 23 Minutes

Hospital | 16 Minutes

Piraeus Municipal Theater | 10 Minutes

University Of Piraeus | 17 Minutes

Bakery & Pastry Shop | 10 Minutes

Themistokleous Square | 8 Minutes

Shopping Mall | 5 Minutes

Lipasmata Multi-purpose Park | 38 Minutes

Piraeus Archaeological Museum | 21 Minutes

Votsalakia Beach | 21 Minutes

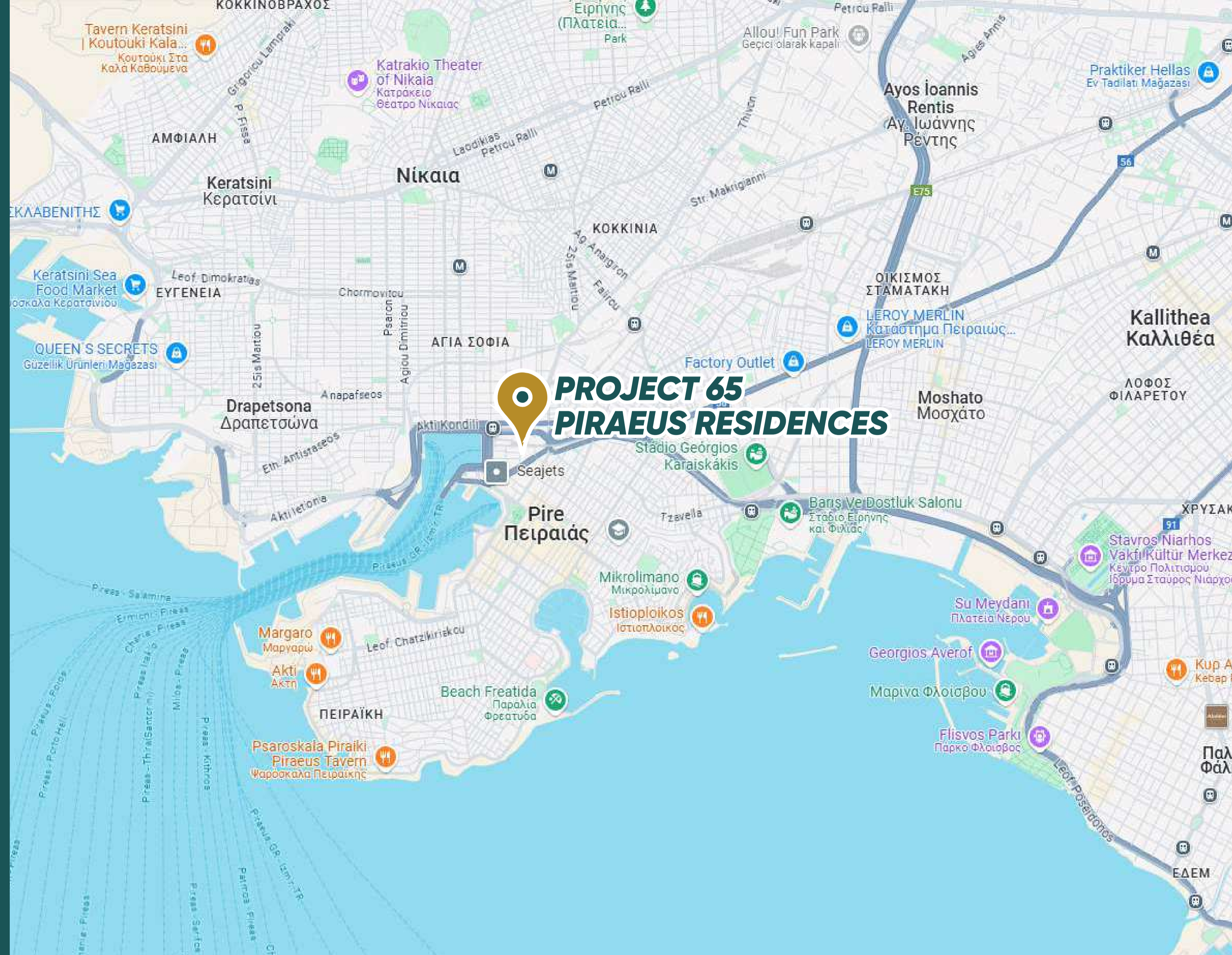

to Invest Global

Kerem KORALAY

Sales Manager

 TR : +90 533 127 98 98

 kerem@toinvestglobal.com

 Atatürk Cad. No: 69 Mesa Koz K: 10 Ofis : 144
Kadıköy / İstanbul

 www.toinvestglobal.com



Kerem_ToInvestTurkey

 /toinvestglobal

 /toinvestglobal

 /toinvestglobal

 /toinvestglobal